

LUBE TRUCK

DESCRIPTION

NEVER USED - This is a heavy-duty, 8 x 8 lube truck on an all-terrain, Renault Kerax 440.42 chassis. The lubrication equipment was manufactured by LaFon Technologies. The truck has 8 stainless steel tanks, air compressor, pumps, and all piping and hoses necessary for it to provide lubrication maintenance for heavy-duty equipment operating onsite in remote applications. All the tanks and operating equipment are fitted inside a standard ISO container making it easy for maintenance access to the lube distribution equipment.



ID	13C-AR03
Chassis	Renault
Model	Kerax 440.42, HD 8X8
LUBE EQUIP. OEM	Lafon Technologies
VIN No.	VF634ZPA000000064
YOM	2013
TRAILER CONTAINER TYPE	CX05-41CPI

	FEATURES
OIL DISPENSING TANKS	6
GREASE DISPENSING TANK	1
COOLANT DISPENSING TANK	1
TANK MATERIAL	304 Stainless Steel
EQUIPMENT STRUCTURE	Standard ISO Container
ACCESS DOORS	1 Side Door 2 Rear Doors



YOU MINE. WE SELL.

+1 (530) 534-7965
info@amking.com

LUBE TRUCK

LUBRICATION EQUIPMENT

EQUIPMENT STRUCTURE

- All equipment is integrated into a modified ISO container – 9778mm.
- Modifications to the structure of the container, include creation of access doors and ventilation
- The ISO container allows for easy assembly / disassembly of the module
- All tanks independently fixed to the floor and ceiling



DESCRIPTION OF THE STORAGE TANKS

- Made from 304L, 5mm thick stainless steel
- Three visual gauges except for the grease tank
- One stainless steel D600mm manhole closed with bolts
- Two baffle by the 7000 liters tank (except for the grease)
- One drain
- One vacuum breaker
- One safety valve
- One pump suction port (DN50 or DN80 depending on the product)
- One tank filling orifice (DN50 or DN80 depending on the product)

LUBE TRUCK TANKS				
TANK TYPE	VOLUME (LITERS)	HEIGHT (mm)	WIDTH (mm)	LENGTH (mm)
OIL	7000	2200	1500	2150
OIL	3000	2200	1500	950
OIL	2500	2200	1500	800
OIL	2000	2200	1500	800
OIL	2000	2200	1500	650
OIL	2000	2200	1500	650
COOLING FLUID	3000	2200	1500	950
GREASE	3000	2200	1500	950



YOU MINE. WE SELL.

+1 (530) 534-7965
info@amking.com

LUBE TRUCK

LUBRICATION EQUIPMENT- OIL SYSTEM

6 OIL TANKS – EQUIPMENT SUMMARY

- Various sizes: 2000 to 7000 liters (see 2nd page chart)
- Calculation basis: 220 centipoise (cps) theoretical flow rate: 40 l / min
- 1 DN50 filling connection fitted with for manual connection at the bottom of the tank
- 1 Connection for the air vent on the roof of the tank
- 1 Connection for the vacuum breaker on the roof
- 1 Connection for the safety valve rated at 3 bars on the roof, with its hose to channel the oil
- 3 Visual gauges of outer tank level
- 1 DN50 suction connection fitted with a manual valve
- 1 Flexible DN50 PS 7 Bars, 1M Long
- 1 Piston pump 6/1 pump cylinder of 2000cc / cycle mounted on a footing (maximum flow rate of 119.21 / min at 60 cps without pressure drop
- 1 Hydraulic filter
- 1 Purge valve
- 1 DN50 valve to isolate the pump outlet
- 1 Supply hose for DN50 PS50 Bars
- 1 Double branch oil reel DN20 PS 86 bars 15 m long
- 1 Distribution handle fitted with digital volumeter with preselection of maximum flow
- 53L / min rigid nozzle without connection



OIL PUMP

- 1 suction pipe fitted for the 200-liter barrel
- 1 suction hose, 3m long DN40
- 1 HUSKY 1590 350 l / min diaphragm pump at maximum free flow, it should start at 100 l/min
- 1 double branch reel with 9m of flexible DN25 special for the aspiration (the reel is unrolled to connect the pump to the ground)
- 1 flexible hose coming from the main pipe
- 1 double branch air hose reel DN15, 15m long, PS 20 Bars
- 1 Staubli type quick coupling fitting
- 1 air regulator fitted with its pressure gauge mounted directly on the pump

Note: Suction pump is mobile; moved as needed by the operator



YOU MINE. WE SELL.

+1 (530) 534-7965
info@amking.com

LUBE TRUCK

LUBRICATION EQUIPMENT

1 LIQUID COOLANT TANK

- 3000 Liters
- Calculation basis: 220 centipoise (cps)
theoretical flow rate: 40 l / min
- 1 DN50 filling connection fitted with for manual connection at the bottom of the tank
- 1 Connection for the air vent on the roof of the tank
- 1 Connection for the safety valve on the roof
- 1 connection for the vacuum breaker on the roof
- 1 Connection for the safety valve rated at 3 bars on the roof, with its hose to channel the oil
- 3 Visual gauges of outer tank level
- 1 DN50 suction connection fitted with a manual valve
- 1 Flexible DN50 PS 7 Bars, 1M Long
- 1 Piston pump 3.5 / 1 pump cylinder of 1000cc / cycle mounted on a footing
- 1 Hydraulic filter
- 1 Purge valve
- 1 DN50 valve to isolate the pump outlet
- 1 Supply hose for DN50 PS50 Bars
- 1 Double branch oil reel DN20 PS 86 bars 15m long
- 1 Distribution handle fitted with digital volumeter with preselection of maximum flow
- 53L / min rigid nozzle without connection

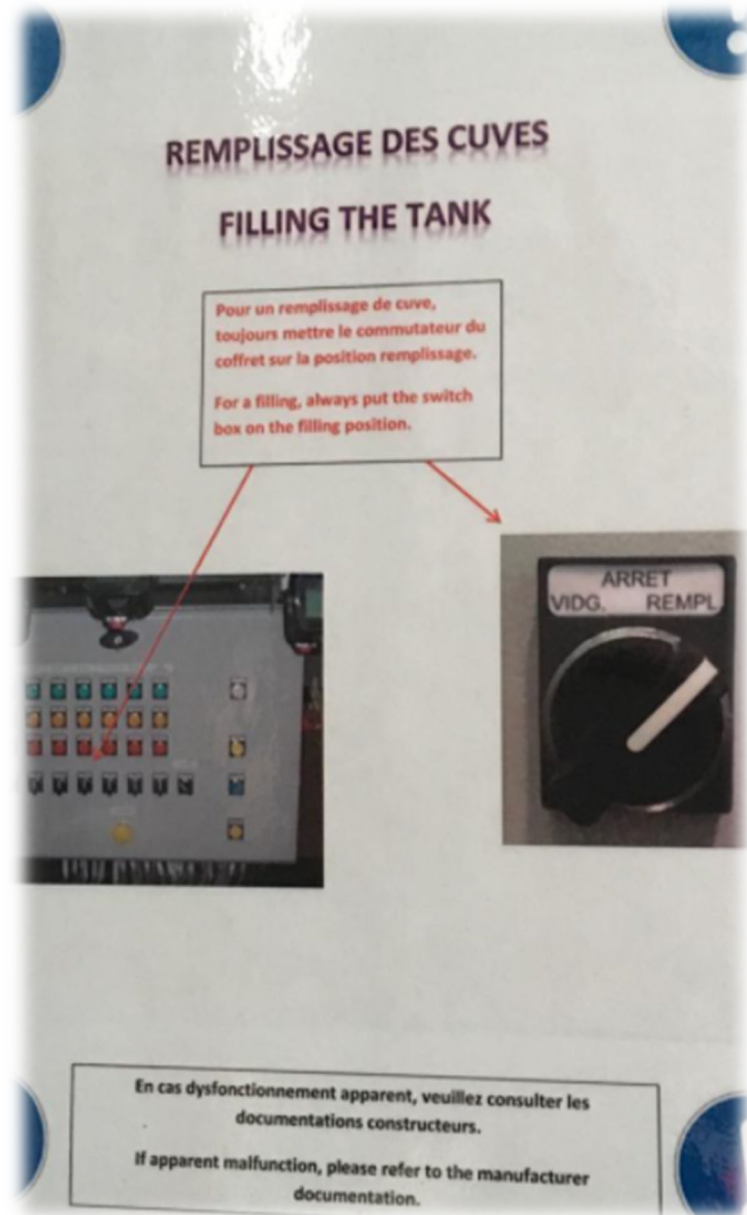

YOU MINE. WE SELL.

+1 (530) 534-7965
info@amking.com

Pre-Owned Mining, Processing & Construction Equipment Since 1979

LUBE TRUCK

LUBRICATION EQUIPMENT

1 GREASE TANK

- 3000 Liters
- 1 DN80 filling connection fitted with a manual valve at the bottom of the tank
- 1 Connection for the air vent on the roof of the tank
- 1 Connection for the safety valve on the roof
- 1 Connection for the safety valve rated at 3 bars on the roof, with its hose to channel the grease.
- 1 DN 80 filling connection fitted with a manual cutoff valve
- 1 Dylatoflex DN80 sleeve
- 1 Stainless steel hose DN80 PS 7 bars 1m long
- 1 Piston pump @ 55/1 displacement of 250cc / cycle mounted on a footing
- 1 Branch for 2 uses
 - Large Flow: we start with a viscosity of 225,000 Cps theoretical flow of 3.5 l / min at 14 cycles per minute
 - 1 purge valve
 - 1 DN40 valve to isolate the high flow part
 - 1 flexible hose diameter 25mm long, 15mm without reel PS 320 bars
 - DN15 PS 345 bars 15m long pay attention to the pressure drop
 - 1 HP DN40 manual valve without connection
 - Small Flow: max 11 / min at 4 cycles per minute
 - 1 purge valve
 - 1 DN25 valve to isolate the small flow part
 - 1 flexible hose diameter 25mm long, 15mm without reel PS 320 bars
 - 1 dispensing handle with digital display, maximum flow rate 1 kg / min without connection

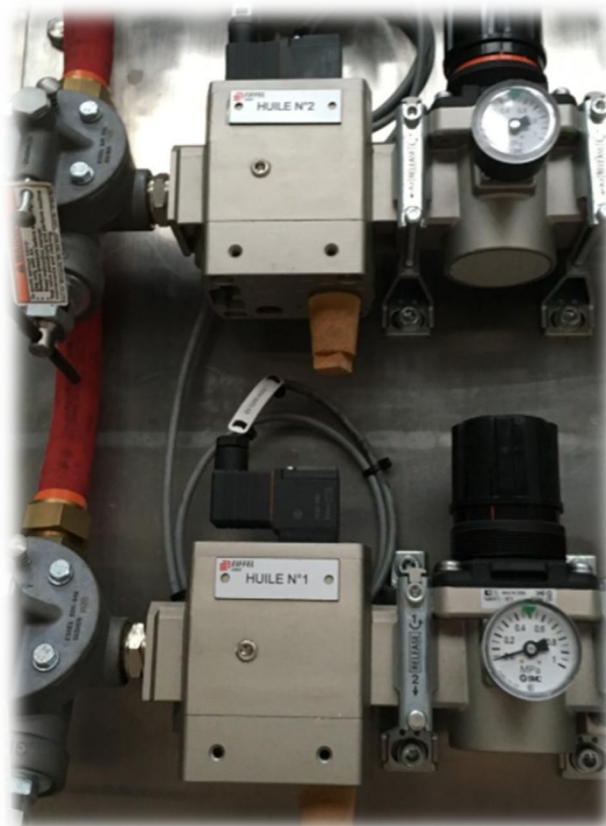

YOU MINE. WE SELL.

+1 (530) 534-7965
info@amking.com

Pre-Owned Mining, Processing & Construction Equipment Since 1979

LUBE TRUCK

LUBRICATION EQUIPMENT

AIR COMPRESSOR

- 1 installation of an air filter 5 μ
- 1 DN50 air hose for feeding from the main pipe
- 1 DN50 stainless steel pipe placed over the entire length of the tanks
- 1 connection fitted with an isolation valve and a flexible hose for:
 - 8 piston pumps
 - 1 for the air reel
 - 1 in reserve
- Piston compressor
- Two-cylinder & two-stage
- Pressure 10/12 bar
- Volume generated 56 m³ / h
- Actual flow rate at 12 bar: 45 m³ / h
- 230-liter steel tank



YOU MINE. WE SELL.

+1 (530) 534-7965
info@amking.com

Pre-Owned Mining, Processing & Construction Equipment Since 1979

LUBE TRUCK

RENAULT CHASSIS

RENAULT CHASSIS FEATURES:

- The frame is reinforced by a subframe. This mechanically welded structure meets the manufacturer's camber guidelines.
- ADR
- Transmission oil cooler.
- Opti-Brake System
- Speed limiter
- Reverse gear buzzer
- Beacons on cabin
- Goodyear tires 385 / 65RHS2 + 315 / 80R22.5RHD2 +
- Power take-off with splined hollow shaft output
- Air conditioning
- Pneumatic driver's seat, adjustable passenger seat
- Wide angle mirrors
- Setup for Radio and CB Equipment

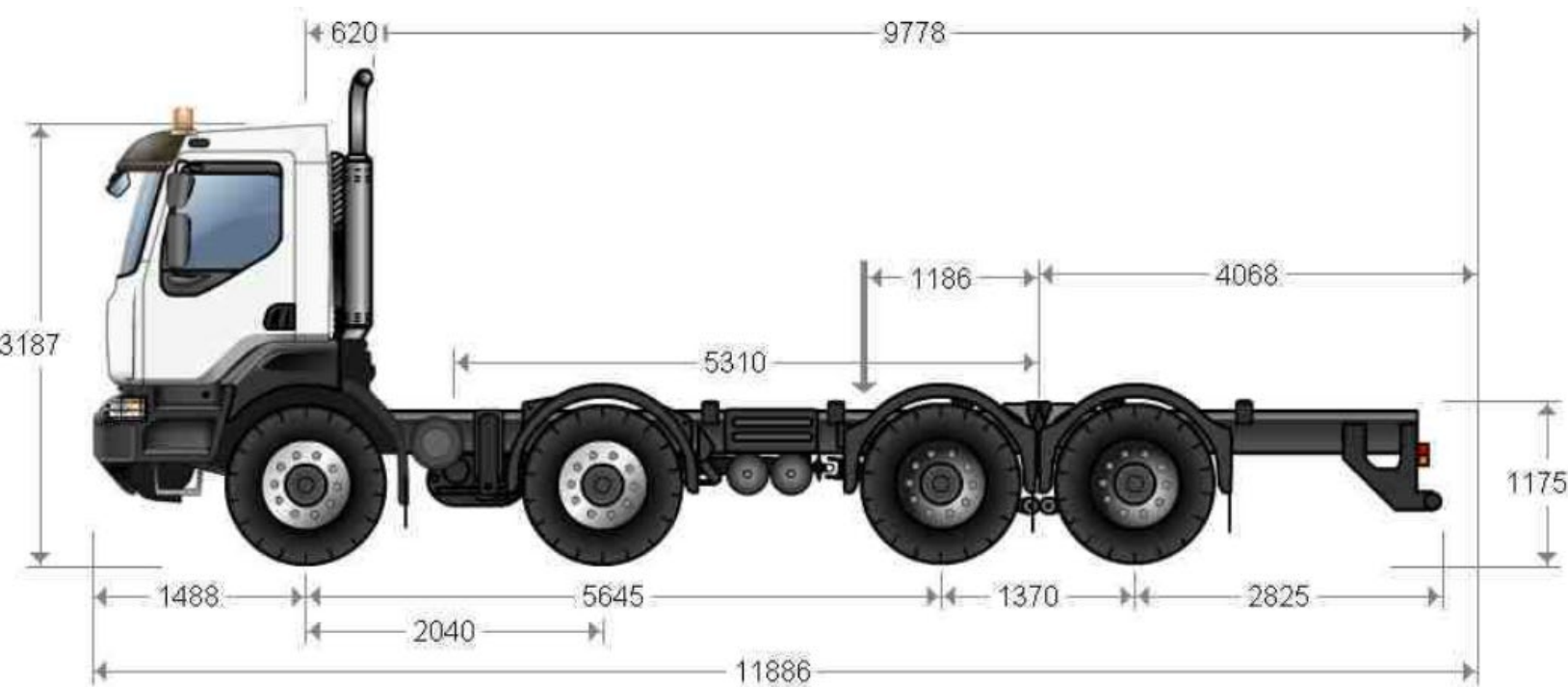

YOU MINE. WE SELL.

+1 (530) 534-7965
info@amking.com

Pre-Owned Mining, Processing & Construction Equipment Since 1979

LUBE TRUCK

RENAULT CHASSIS

MOTOR DXi11:

- Maximum power: 321 kW at 1900 rpm.
- Maximum torque: 2000 Nm at 1150 rpm.
- 6-cylinder in-line diesel, supercharged by INTERCOOLER turbo.
- high pressure electronic injection (2000 bars) by injectors
- 2nd generation pumps.
- 24-valve monobloc cylinder head, overhead camshaft, rear timing
- Bore 123 mm - stroke 152 mm - Displacement 10.8 l.
- Engine oil capacity: 36 liters.
- Steel oil pan.
- Large capacity disposable cartridge oil filter.
- Cooling circuit capacity: 33.5 liters (51 liters with hydraulic retarder).
- Pilot operated starter.
- Electronically controlled fan.
- Direction of rotation (view from BV side): anti-clockwise.
- EEC EURO 3 Emissions level.

ENGINE EQUIPMENT

- Aluminum flywheel housing.
- Electronic idle speed regulator.
- Without engine power take-off.
- Electronic speed limiter (90 km / h).

CLUTCH

- 430 GD 900 (430 MFZ on OptiDriver)
- Single disc. Hydraulic control and pneumatic assistance. Automatic Catch-up.

GEARBOX

- ZF 16 S 2230 TO 16 synchronized forward gears and 2 reverse gears (13.8 - 0.84).
- Aluminum housing.
- Pneumatic range doubler with preselection valve on the lever.
- Super H control grid. Gear change assisted by SERVOSHIFT cable control.
- Economic driving assistance DMS (Driving Monitoring System).

RETARDER

- OPTIBRAKE: Combination of the exhaust retarder and the valve compression brake. Fully managed by electronic (power of 303 kW at 2300 rpm), coupled to the service brake.

TAKEOFF POWER

- Power take-off S81 C.
- Output: splined hollow shaft for flanged pump.
- Direction of rotation: reverse motor. Torque: 1000 Nm. Ratio: 0.92 / 1.09 Position: 15h

DIRECTION

- Box with incorporated hydraulic assistance with variable gear ratio.
- Hydraulic assistance with 1 independent circuit and 1 pump.

FRONT AXLE

- Front axle P995. Double reduction by conical torque and reducers in the hubs (2.26).
- Front load capacity (technical max): 9,000 t x 2

TRANSFER BOX

- VG 2000/300
- Separated from the gearbox.
- Ratio: PV 1 / 1.536 - GV 1 / 0.890.
- Non-permanent transfer box:



YOU MINE. WE SELL.

+1 (530) 534-7965
info@amking.com

LUBE TRUCK

RENAULT CHASSIS

REAR AXLE

- Tandem PMR 3361
- Capacity 32 tons, double reduction by conical torque and reducers in the hubs (3.46).
- Torque 14 x 25 (ratio 1, 8).

TIRE AND WHEELS

- TIRES AND WHEELS
- G.385 / 65RHS2 + 315 / 80R22.5 RHD2 +
- Steel wheels.
- Spare wheel in temporary fixing with jack.

BRAKING

Service Brake:

- Drum: Diameter 410 mm. Front width 175 mm. Rear width 200 mm. Brake lever 170 mm.
- Total surface area of the linings 19 311 mm². Braking capacity greater than 70 tonnes. Parking brake on three axles.
- Electronic management of air production by APM (Air Product Management) :
- Preventive maintenance optimized dryer cartridge.
- Compressor :Twin cylinder 636 cm³ piloted by APM. Can be disengaged. Maximum flow: 660 liters / min 2000 rpm (compressor).
- Ratio: 1.31

Parking Brake :

- Pneumatically controlled, immobilization provided by spring cylinders. Parking brake valve.
- Settings: Automatic adjustment of the play of the toppings.

Emergency Brake:

- Provided by the parking brake function.

CABIN EXTERIOR

- Electro-galvanized cabin sheet metal, treated by cathoporesis.
- Short cabin (1.6 m). Cabin color: glacier white
- Honeycomb grille with closing strap.
- Anti-dirt deflectors.
- Steel shield in 3 parts integrating a retractable windshield access step, a grille and a protective shoe
- radiator.
- Mechanical cab suspension on 4 points.
- Hydraulic cab tilting.
- 2 manually adjustable mirrors.
- Wide-angle mirrors. Docking mirror.
- Air intake duct on the left side roof level.
- Additional retractable step for access to the windscreen.
- Access to the driving position by 3 steps. 1st flexible steps in composite material.
- Step lighting.
- Translucent visor visor, predisposition for additional headlights.
- Tinted laminated windshield and tinted windows.
- Rear window.
- 2 orange beacons.

DRIVING EQUIPMENT

- Steering lock.
- Control of 2 windscreen wipers with incorporated jets, 2 speeds and intermittent wiping.
- Control of retarder and OPTIBRAKE.



YOU MINE. WE SELL.

+1 (530) 534-7965
info@amking.com

LUBE TRUCK

RENAULT CHASSIS

CABIN INTERIOR

- Normal pavilion equipped with storage service:
- - 2 ISO modules.
- One-piece top storage trolley with a volume of 50 liters.
- Roof vent.
- Pneumatic suspended driver's seat with seat belt and incorporated headrest.
- Adjustable passenger seat with seat belt and armrest
- Grab handles
- Soft door trim.
- Storage compartment in the doors.
- Car lighting delay.
- Blow gun socket on gear control console.
- Sound insulation of the cabin.
- Air conditioning for dusty atmosphere.
- Logbook in English Export.
- Radio pre-equipment
- Predisposition C.B.
- Radio telephone predisposition (wiring + antenna on the roof).
- Hour meter (recording of engine operating times).
- Passage cabin partition.

ELECTRONIC EQUIPMENT

- Battery capacity 170 Ah.
- 24 volts voltage provided by 2 batteries.
- High amperage fuse box in the battery compartment.
- General external switch.
- Alternator 110 A.
- EEC lighting. Electric headlamp adjustment device. Headlight protection grilles.
- Rear signaling lighting (EEC standard).
- Rear lights on dedicated support.

DASHBOARD

Digital display with:

- Speedometer, display of car radio information, hours, exterior temperature.
- Display of driving information.
- Driver alert messages and display of the various menus.
- Analog reading:
- Central tachometer with economical use zone, gauges for fuel, air pressure, engine water temperature.
- Double flashing markings (tractor and trailer).
- Function and warning lights.
- Anti-reflective glass.
- Display menu control via the radio satellite positioned on the steering wheel.
- Adjustment of light intensity.
- Without control graph.
- Nomadic ashtray and cup locations.
- Raised engine tunnel

CHASSIS

- Battery capacity 170 Ah.
- 24 volts voltage provided by 2 batteries.
- High amperage fuse box in the battery compartment.
- General external switch.
- Alternator 110 A.
- EEC lighting. Electric headlamp adjustment device. Headlight protection grilles.
- Rear signaling lighting (EEC standard).
- Rear lights on dedicated support.



YOU MINE. WE SELL.

+1 (530) 534-7965
info@amking.com

LUBE TRUCK

RENAULT CHASSIS

SUSPENSION

Front Suspension

- 2-leaf parabolic front springs (9 tons). Front stabilizer bar.

Rear Suspension

- Rear semi-elliptical leaf springs. Stabilizing bar.
- Telescopic shock absorbers.
- For Very Bad Road uses: 32T capacity
- 8x8 forwarder and tractor: 9 elliptical blades
- For track use: the capacity is increased to 38T in the 4-blade parabolic version

FUEL TANK

- Main steel tank capacity: 255 liters. (i.e. 206 kg of diesel)
- 560mm diameter "D" shaped profile.
- Lockable cap.
- Large capacity decanter prefilter (R120) reinforced on frame.

STANDARD EQUIPMENT

- Right vertical exhaust.
- Lot edge
- Warning triangle.
- Reverse buzzer.

BODY

- Front corbels and rear mounting plates for rigid mounting.
- 24V / 200A power supply terminal block in battery box.
- Predisposition for 7-way round socket under battery box:
- APIG 24V / 15A + earth power supply (shared cabin).
- APC 24V / 15A power supply + earth.
- Sidelights.
- Trailer module alarm connection.
- Air intake on frame for bodybuilder.
- BBM bodybuilder interface electronic box (bodybuilder expert functions via CAN bus).

EQUIPMENT STRUCTURE

- Metal sub-frame clamped to the supporting frame
- 2 locking arms, specific adapted locking center distance
- 4 guide rollers for placing the body in line.
- 2 front stops at the end of the sub-frame
- For container loading according to final dimension.
- Detachable locks for the complete module.

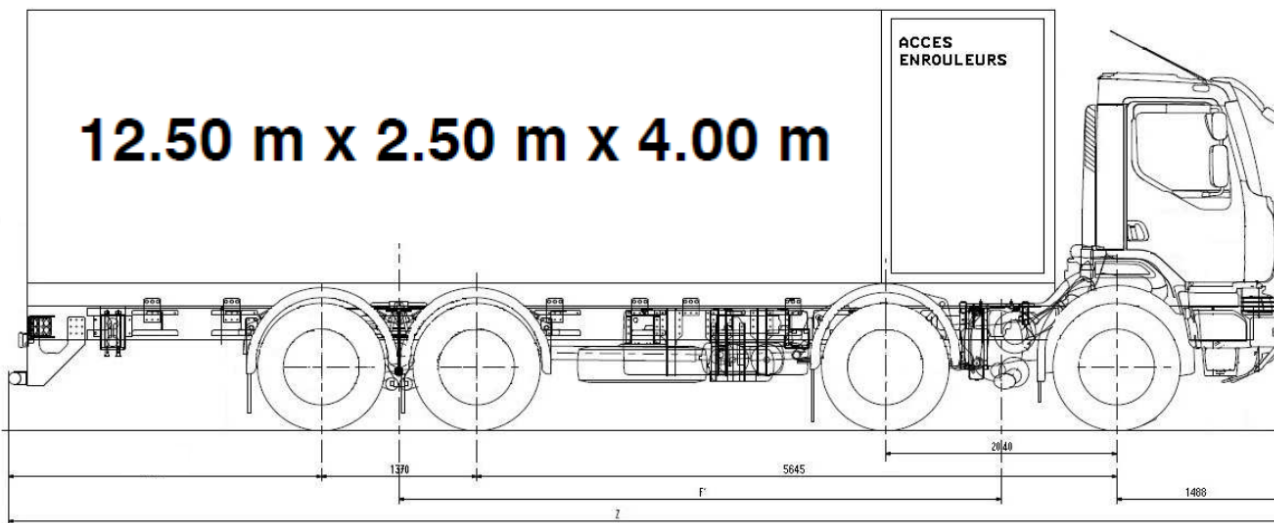

YOU MINE. WE SELL.

+1 (530) 534-7965
info@amking.com

Pre-Owned Mining, Processing & Construction Equipment Since 1979



YOU MINE. WE SELL.





YOU MINE. WE SELL.





YOU MINE. WE SELL.

KERAX
XTREM

440 Dxi

RENAULT TRUCKS
E9 113R 110 01157

RENAULT TRUCKS

VF634ZPA0000000064

	32000	kg	0,80
	44000	kg	
1	9000	kg	E2 2910
2	9000	kg	
3	10500	kg	
4	10500	kg	
		kg	

34ZPA1

RENAULT TRUCKS

VF634ZPA0000000064

L		m
W		m
a	min	m
	max	m

82523748

E2 11015 1R 105 1081015 | AT

DATE INSTALLATION 30/09/2013

W: 15635 IMP/KM L: 03524MM

DATE MESURE: 30/09/2013

W ET L:

PNEUMATIQUE: 385/65-13 R22,5 PANH

VIN: VF634ZPA0000000064

41159

APPROVED FOR TRANSPORT
UNDER CUSTOMS SEAL

GB/C 16363 LR/2011

TYPE	MANUFACTURER'S NO. OF THE CONTAINER
CX05-41CPI	CXIC 15

Container Providers Int Aps Sankt Annae Plads 7 DK-1250 Copenhagen K Denmark TEL: +45 45 57 05 55 FAX: +45 45 57 06 35 www.cpigroup.com	TIMBER COMPONENT TREATMENT IM / RADALEUM FHP-60/2012
MANUFACTURED BY: CONTAINER PROVIDERS INTL. APS (As Agents Only)	

CSC SAFETY APPROVAL

GB-LR 21654-2/2011

DATE MANUFACTURED	/20	FIRST MAINTENANCE EXAMINATION DATE /20
IDENTIFICATION NO.	CPIU 583 341	
MAXIMUM GROSS WEIGHT	30,480 KGS. 67,200 LBS.	
ALLOW. STACK. WT. 1.8G	192,000 KGS. 423,280 LBS.	
BACKING TEST LOAD VALUE	15,240 KGS. 33,600 LBS.	